

For initial setup the speaker system can be assembled and tested on a table top. Then install on the pole.



Clip-on MIC

Other Details

This wireless system operates in the 2.4Ghz region and uses 1 of 20 available channels that are automatically selected. There are 4 models of operation. The AUX AUDIO input or the MIC input can be set to have priority over the other. The wireless mic operating range is beyond 80 feet. The transmitter contains a Li battery. Multiple systems should be at least 18 feet from each other.

Charging the MIC TRANSMITTER Battery

The miniature MIC TRANSMITTER is charged using the cable with the USB connector and the small DC power connector pin which inserts into the top of the TRANSMITTER. The USB end is plugged into a powered USB port such as on a computer. A constant on red LED indicates the battery is charging.

Please be sure the USB port remains active. If the computer goes to sleep the port will go OFF and the port will discharge or drain the TRANSMITTER battery

Installing on a pole

- 1** Place the foam pads on the inside of the speaker.

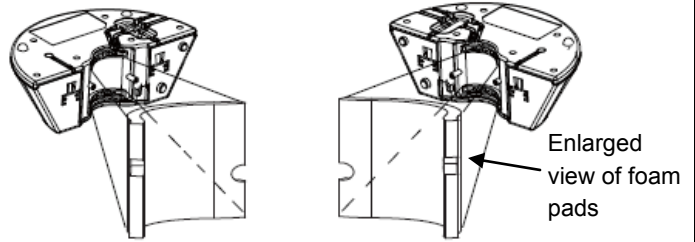

- 2** Connect the 2 halves of the speaker around the pole using the metal hooks. Insert a wedge to hold the speaker in place if necessary.

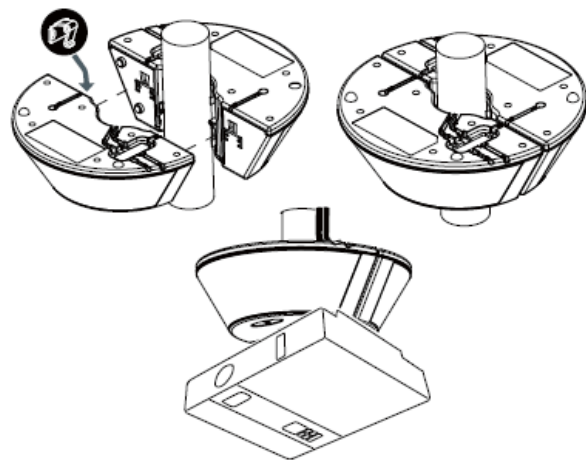

4. Audio Cable connections

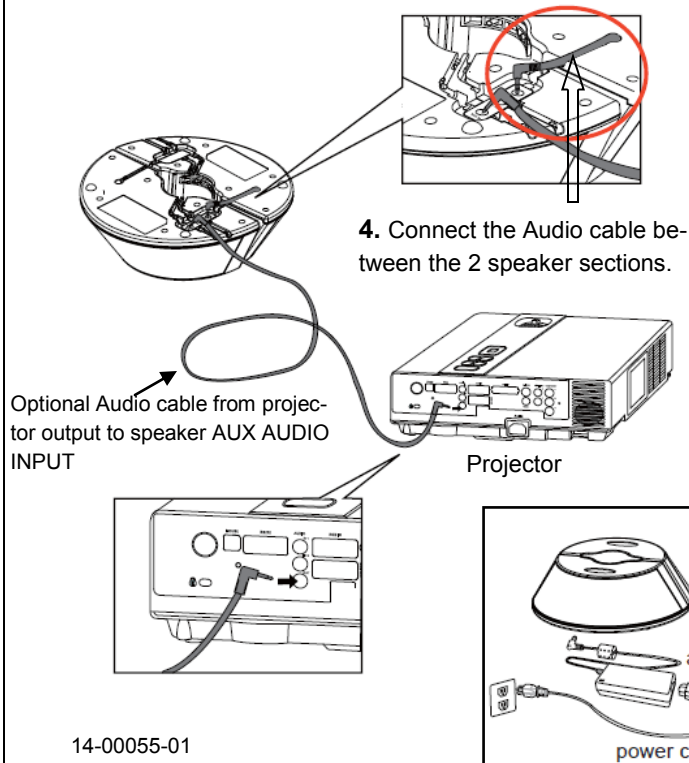

Speaker top view connections

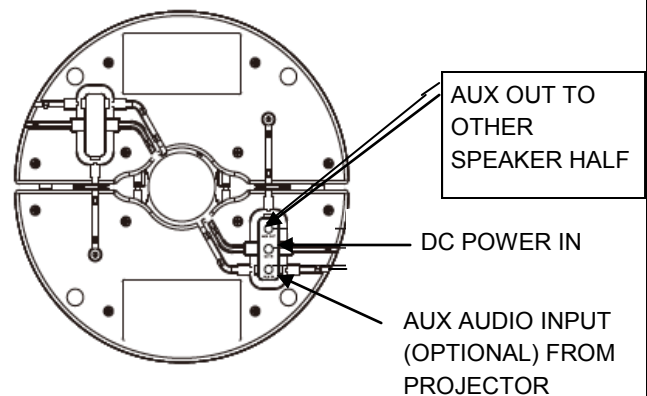

- 5.** Connect the DC Power cable to the speaker top. Then plug in the power adapter to the 115VAC. A blue LED will be visible behind the black speaker grill.

Microphone and Transmitter (See images below)

1. Plug the Clip-on Mic cord into the center MIC phone jack on the Transmitter.
2. Bring the Mic/ Transmitter within 8 feet of the Speaker.
3. Turn ON the mini Transmitter (Power ON). Red LED Signal light will appear.
4. The transmitter will seek the receiver which is inside the speaker. When matching (pairing) is completed, takes about 3 seconds, a beep-beep sound will be heard, While pairing the transmitter red/blue LEDs will flash. Note: Do not cover the bottom of the transmitter during pairing since an IR LED signal is emitted from the transmitter.

If the matching (pairing) of the system does not occur the MIC TRANSMITTER may need to be reset. Turn the MIC TRANSMITTER OFF. Then press and hold a button on the multifunction switch and turn ON the MIC TRANSMITTER. Release the button after the red LED comes ON.

5. The Mic should now be active. Adjust Volume. If no sound is present press the center button on the Multi-functional switch to change the inputs. Also check to see that the speaker is powered ON.
6. The MIC talk time exceeds 8 hours. The red LED on the transmitter starts flashing when there is 1 hour of operating time remaining. Recharge the battery continuously for 4 hours. Use the cable with the USB connector to the USB Power Adapter or to the USB port on a PC.

Mode Setup – Settings for the AUX AUDIO INPUT on the Speaker

There are 4 modes of operation for the AUX AUDIO input on the top of the speaker unit. This Input is located next to the DC INPUT. The audio entering this port can be set to operate in one of 4 ways.

Mode 1. MIC Only: Only sound from the Miniature MIC TRANSMITTER is amplified. No AUDIO AUX (it is turned Off)

Mode 2. Mixed audio; The MIC TRANSMITTER and AUX AUDIO INPUT are mixed.

Mode 3. MIC priority operation; The MIC audio, when present, will have the priority and turn off the AUX AUDIO.

Mode 4. AUX AUDIO INPUT priority; The Aux IN on the speaker unit will have priority over the Mic input .

Setting the mode. The MIC TRANSMITTER is used to set the mode. Start with it OFF.

Mode 1. Hold down the MIC TRANSMITTER key 1 (Volume up) button and turn ON the power.

Mode 2. Hold down the MIC TRANSMITTER key 2 (Right key) button and turn ON the power

Mode 3. Hold down the MIC TRANSMITTER key 3 (Volume down) button and turn ON the power.

Mode 4. Hold down the MIC TRANSMITTER key 4 (Left key) button and turn ON the power.

See the figure.



MINIATURE MIC TRANSMITTER

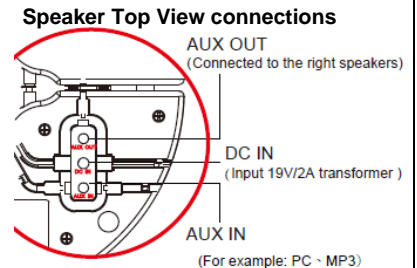
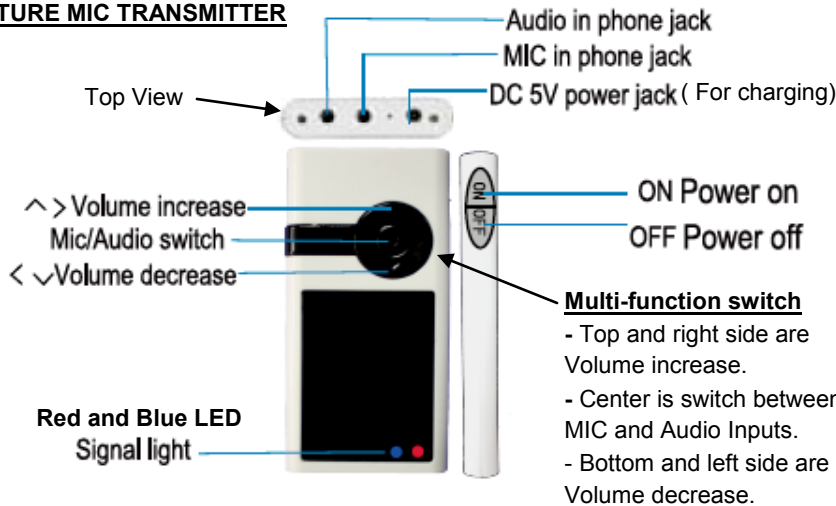

Light Signal Specification

Blue Light	Red Light	Light Instruction
OFF	OFF	Power off
Quick flashing		Matching state
Slow flashing		Match successfully in connecting state
Slow flashing		MIC mode if flash one time every 2.5s
Slow flashing		Audio mode if flash two times every 2.5s
	ON	Charging, red light turns off automatically after charging complete
	Slow flashing	Low power and need to charge if flash one time every 2.5s
	Quick flashing	NO signal connection between mic and speaker

Wireless microphone connection :

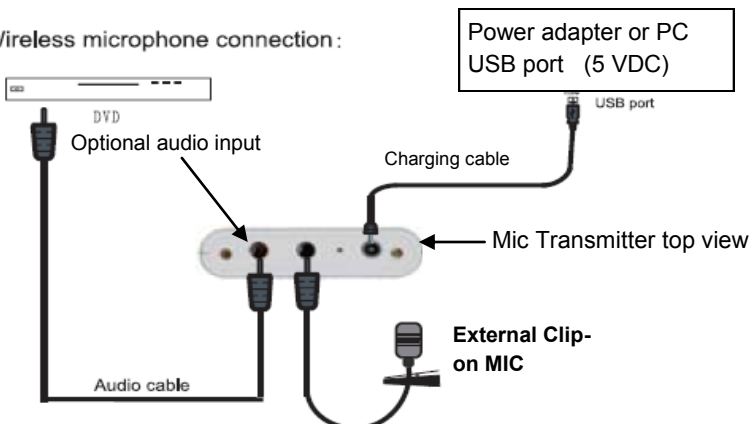

DUKANE CORP AV SERVICE DEPT
 2900 Dukane Drive
 St Charles, IL 60174
 800-676-2487
 Fax 630-584-5156
avservice@dukane.com
<http://www.dukane.com/av/service/>